

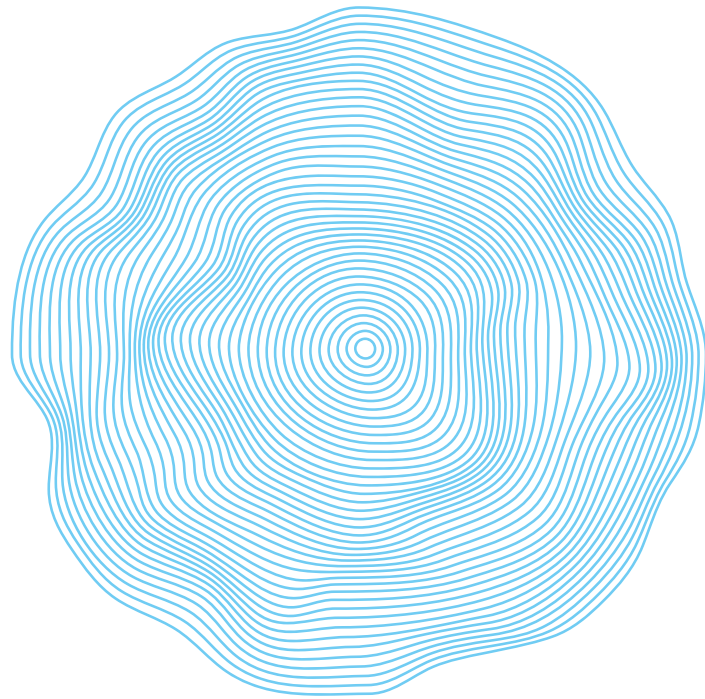

SOBHA HARTLAND



Where Escaping is staying

Enjoy the perks of living by a crystal lagoon in central Dubai



Why make Sobha Hartland
your home?

Views of Ras Al Khor Wildlife Sanctuary and the crystal lagoon.

Located in the epicentre of the city with major landmarks just minutes away.

2 International schools within the Sobha Hartland Community.

3 lush green parks connected by a central pathway for all residents.

Central Park

Acres of green canopies surround you in this exclusive park in Hartland Estates.

Greens East Park

A park designed for outdoor recreation with an amphitheater, kids' play area, rock-climbing wall and a lot more.

Greens West Park

Bringing the forest to your doorstep in this park that is a doorway to a world far away, yet in the centre of the city.

INTRODUCING

THE

CREST



Caribbean-style crystal lagoon facing residences
now have a name

THE
CREST



Residential towers with inter-linked Sky Gardens
now have a name

THE
CREST



Experiential community living
now has a name

THE
CREST



What does The Crest at Sobha Hartland have to offer

- Located on the banks of a pristine **CRYSTAL LAGOON**.
3 inter-connected expansive towers.

- **LIMITED RELEASE**

The Crest Tower A has residences spread across 46 floors.

The 3 towers have a series of stepped **SKY GARDENS** connecting them with each other.

- A host of **AMENITIES** spread across the podium level and the landscaped terraces; curated just for you.
- Residential living space that provides endless moments of **EXPERIENCES**.
- Inter-linked **SKYWALK** that brings all 3 towers of The Crest together.

THE
CREST



A lifestyle worthy of your every day,
with no reason to step out.

THE BOOK OF
 AMENITIES

THE
 CREST



*Images used for representative purpose only

INDOOR

THE
CREST



Health Club with
changing rooms

THE
CREST

Multipurpose Hall





Spin Class Studio

THE
CREST

Pilates Studio





Yoga Studio

OUTDOOR

THE
CREST



Swimming Pool

THE
CREST

Kids Play Area





Barbeque Area

THE
CREST

Pentanque Boules Lawn





Outdoor Gym Terrace

THE
CREST

Tai Che Terrace





THE
CREST

Landscaped Terraces at different levels with a host of amenities

Inter-linked Sky Gardens at different levels





*Images used for representative purpose only

Payment Plan

1, 2 & 3 bedroom apartments starting from

AED 1.1 Mn*

5 year	70%	30%
Payment plan*	Over 4 years	On completion in 2025

THE
CREST

*T&C apply

MASTER PLAN

FLOOR PLANS

RESIDENTIAL UNIT PLANS

THE
CREST

LOCATION IN THE MASTER PLAN

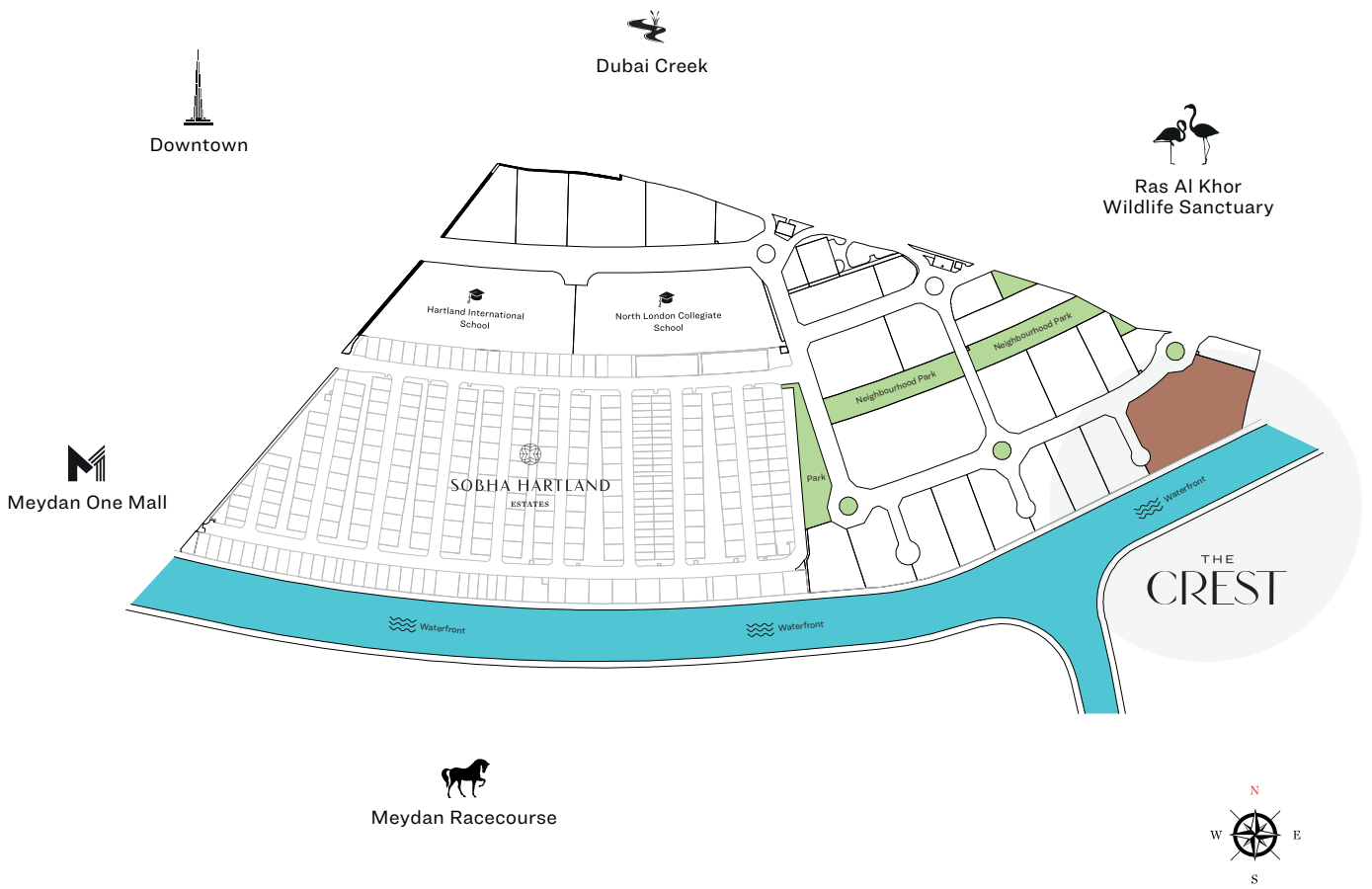

APARTMENT FEATURES



Landmark views



Covered car parking



Fully fitted kitchens



Bedroom wardrobe in all units

FLOOR PLAN LAYOUT

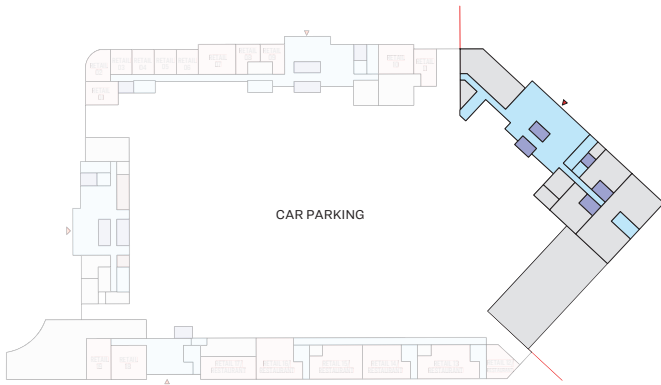
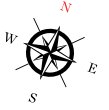

GROUND LEVEL

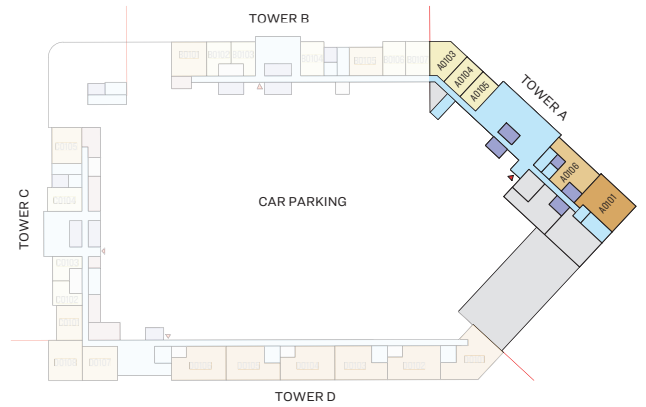

LEVEL-01(PODIUM 01)

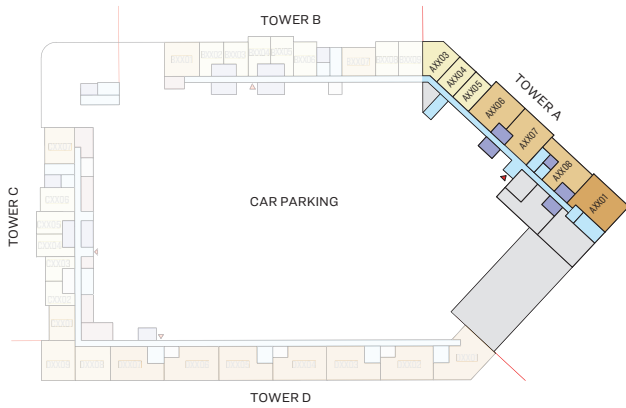

LEVEL-02,03 (PODIUM 02,03) TYPICAL FLOOR PLAN

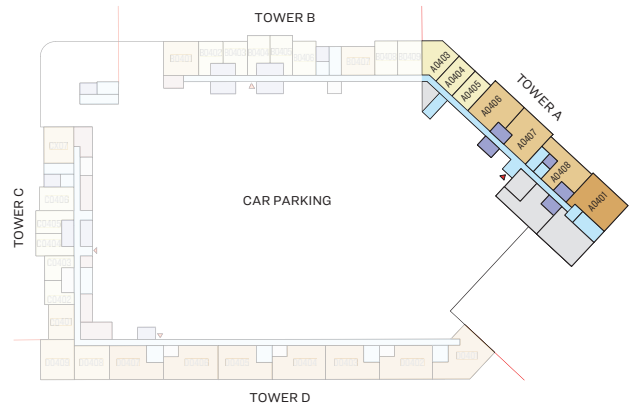

LEVEL-04(PODIUM 04)

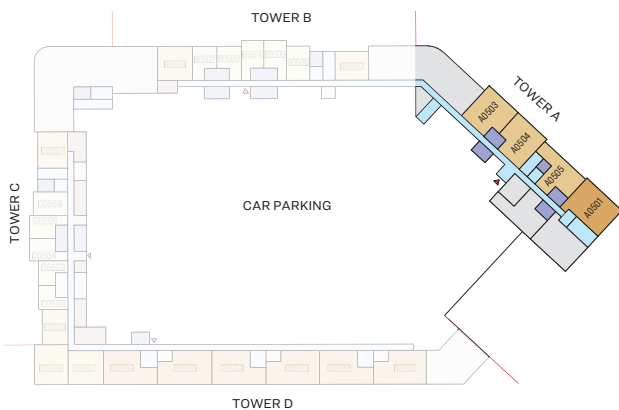

LEVEL-05(PODIUM 05)

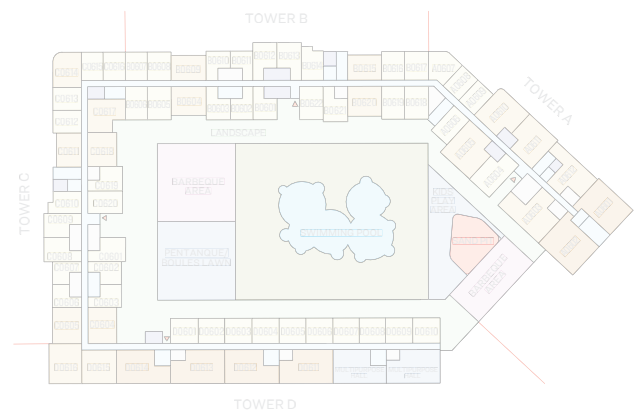

LEVEL-06

- | | | | |
|--|---|---|--|
| 1 BED UNIT | SERVICES | COMMERCIAL | BARBEQUE AREA |
| 2 BED UNIT | LIFT | LANDSCAPE | SWIMMING POOL DECK |
| 3 BED UNIT | AMENITIES | SWIMMING POOL | |
| LOBBIES,CORRIDORS & STAIRS | APARTMENT STORE | SAND PIT | |

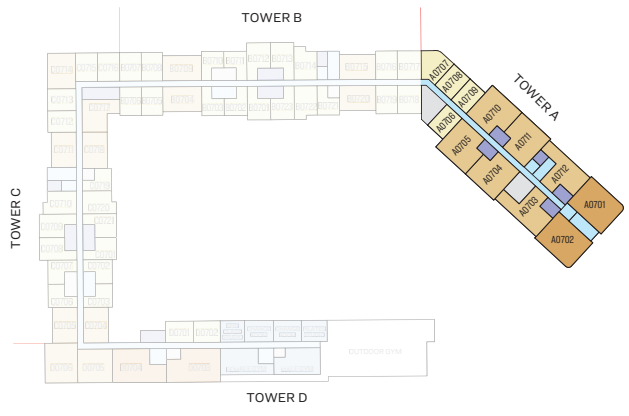
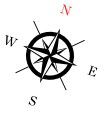

LEVEL-07

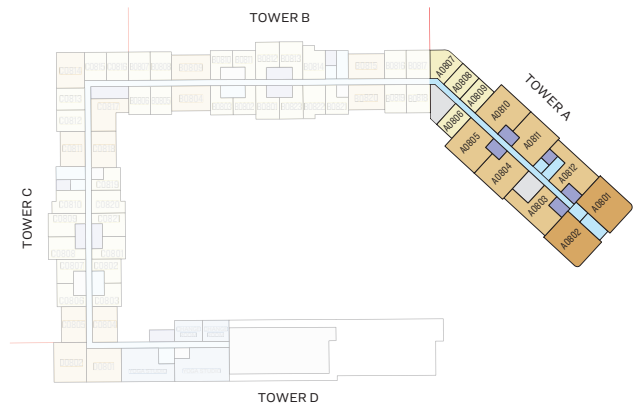

LEVEL-08

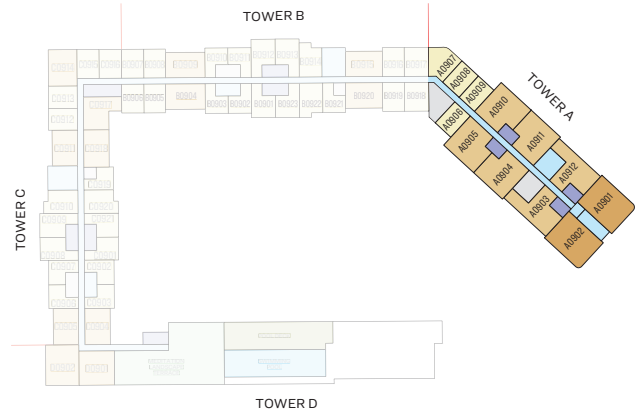

LEVEL-09

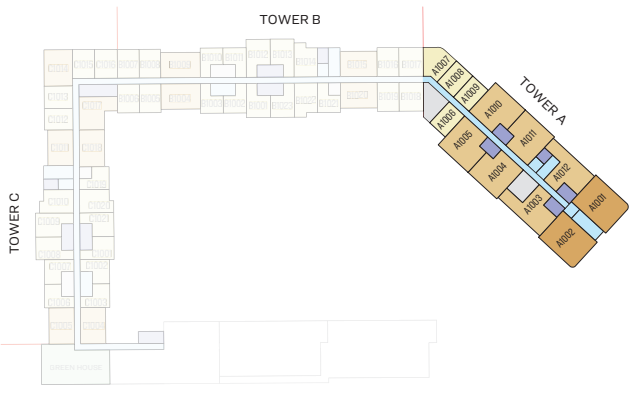

LEVEL 10

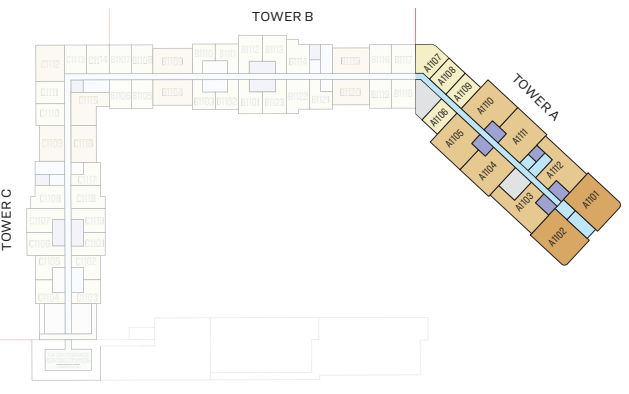

LEVEL 11

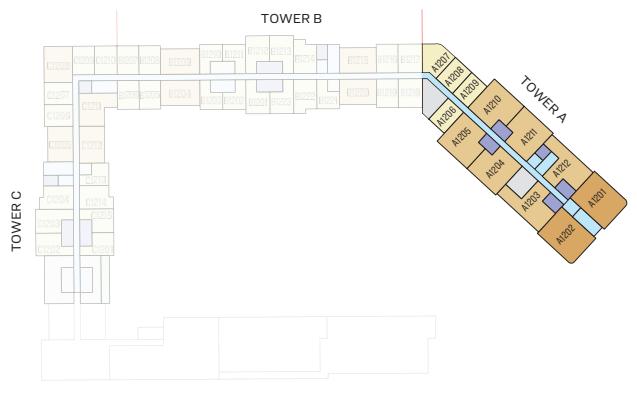

LEVEL 12

- | | | |
|---|--|---|
| 1 BED UNIT | SERVICES | SWIMMING POOL |
| 2 BED UNIT | LIFT | SWIMMING POOL DECK |
| 3 BED UNIT | AMENITIES | |
| LOBBIES,CORRIDORS & STAIRS | LANDSCAPE | |

Disclaimer: 1. Information is subject to change without notice, at developer's absolute discretion. 2. Drawings are not to scale. 3. All images used are for illustrative purpose only and do not represent the actual size, features, specifications 4. The developer reserves the right to make revisions/ alterations, at its absolute discretion, without any liability whatsoever.

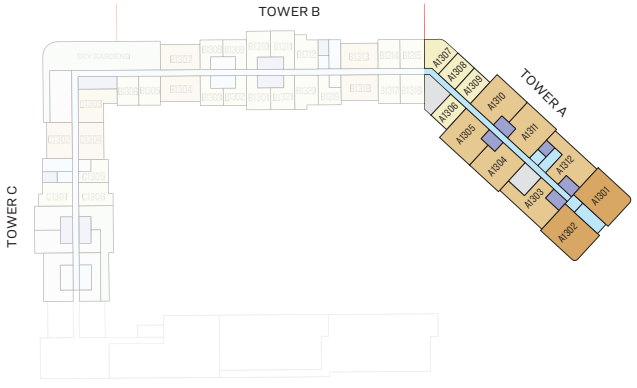
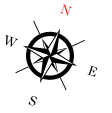

LEVEL 13

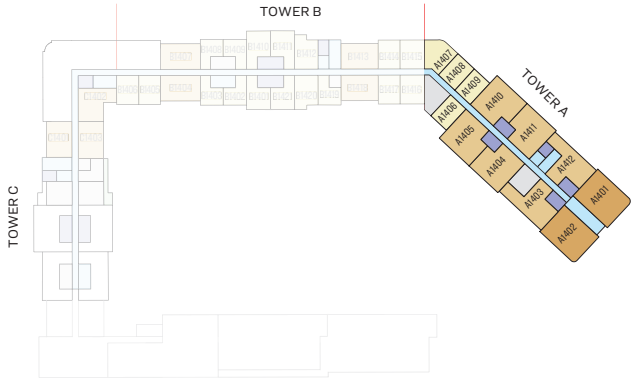

LEVEL 14

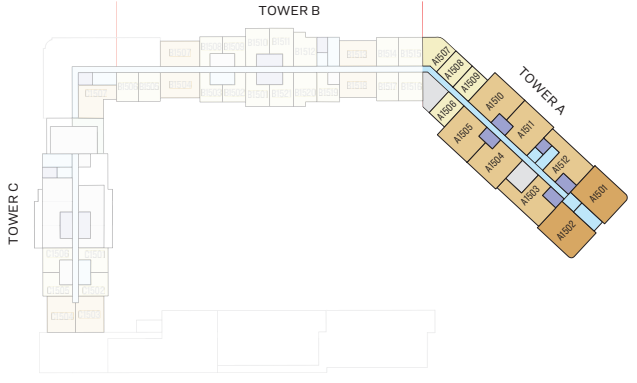

LEVEL 15

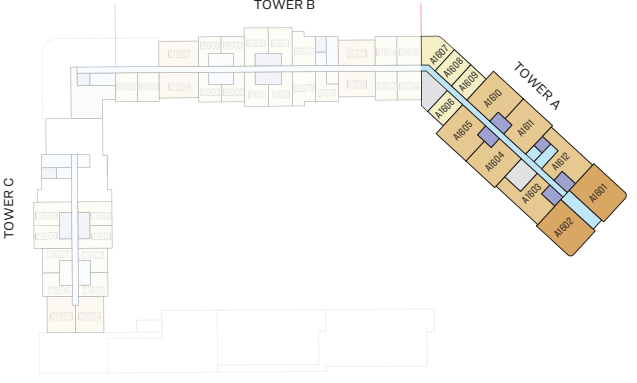

LEVEL 16

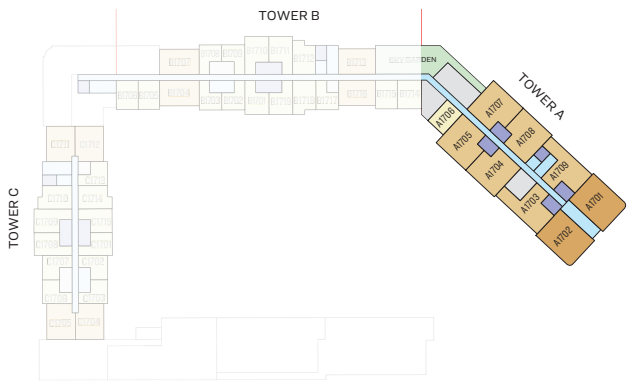

LEVEL 17

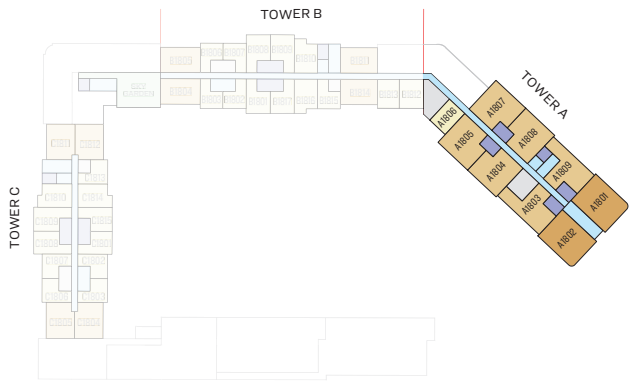

LEVEL 18

- 1 BED UNIT
- 2 BED UNIT
- 3 BED UNIT
- LOBBIES, CORRIDORS & STAIRS
- SERVICES
- LIFT
- AMENITIES
- LANDSCAPE

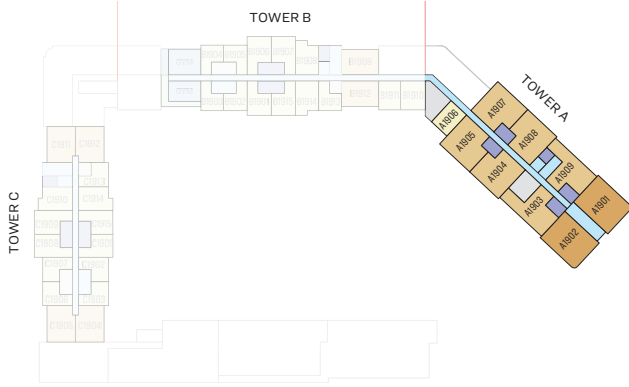
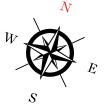

LEVEL 19

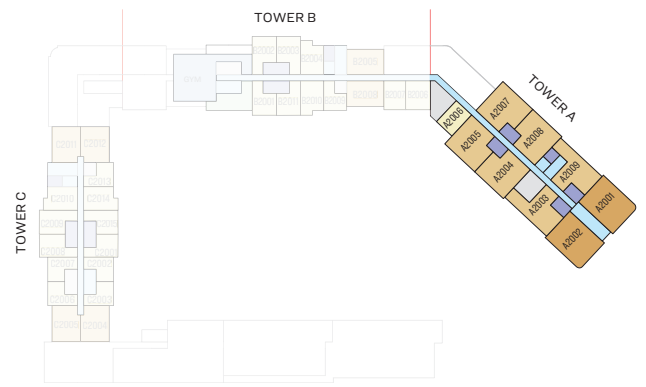

LEVEL 20

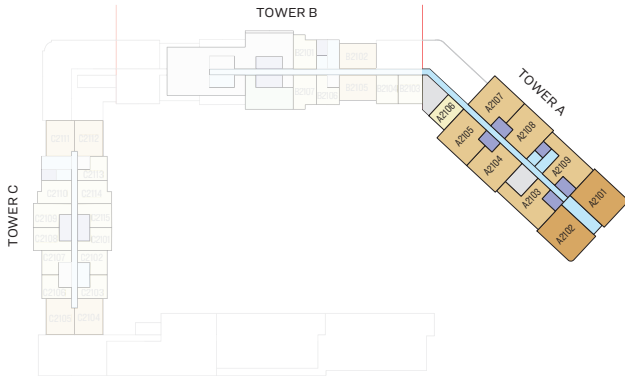

LEVEL 21

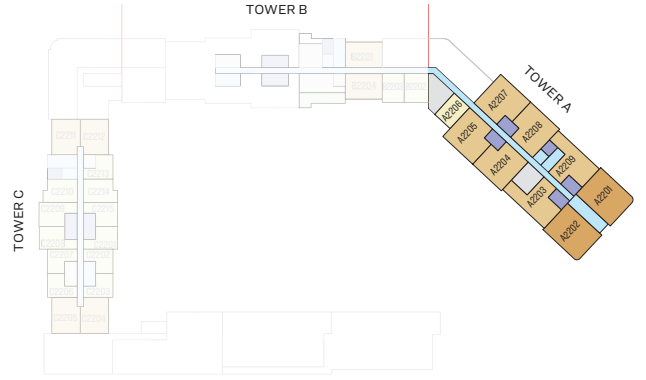

LEVEL 22

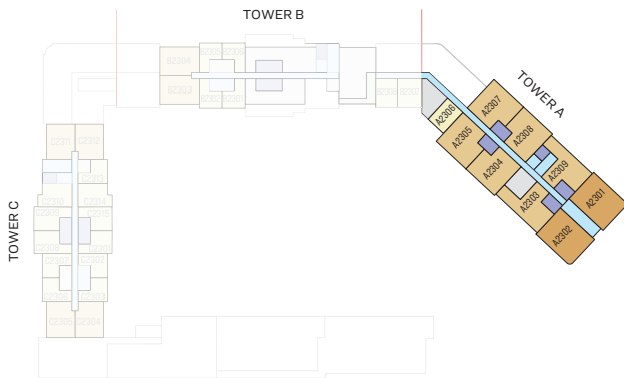

LEVEL 23

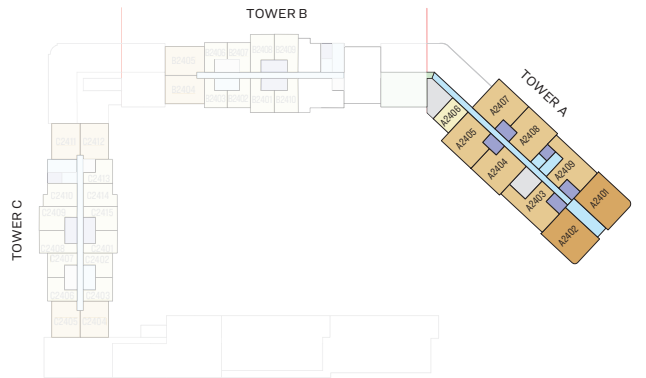

LEVEL 24

- | | |
|-----------------------------|-----------|
| 1 BED UNIT | SERVICES |
| 2 BED UNIT | LIFT |
| 3 BED UNIT | AMENITIES |
| LOBBIES, CORRIDORS & STAIRS | LANDSCAPE |

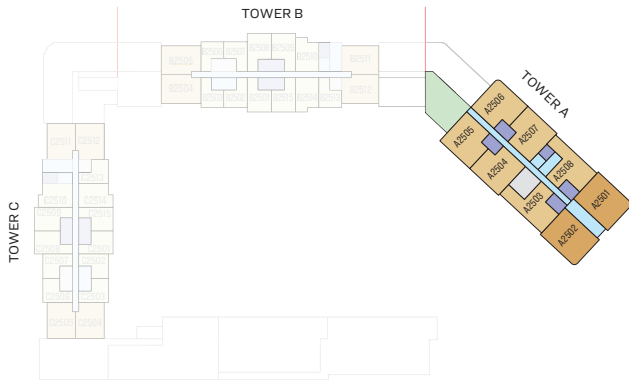
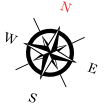

LEVEL 25

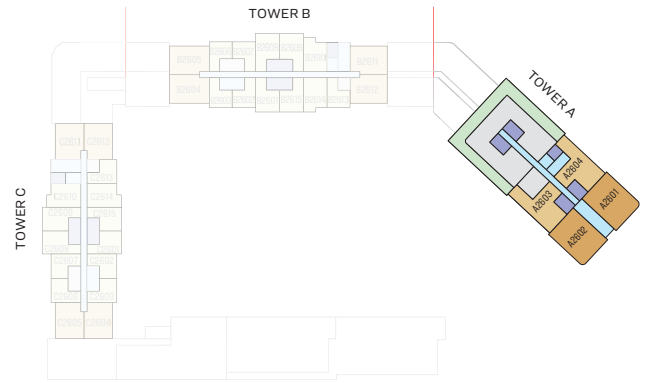

LEVEL 26

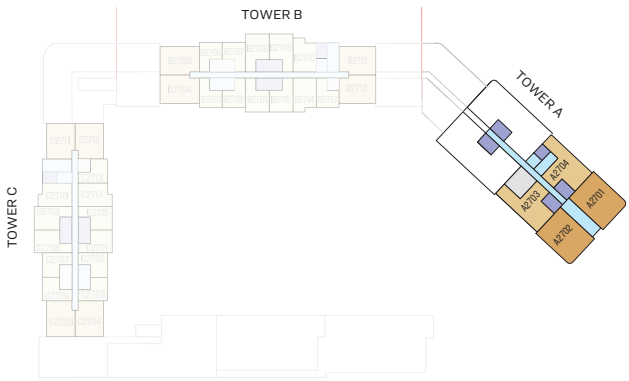

LEVEL 27

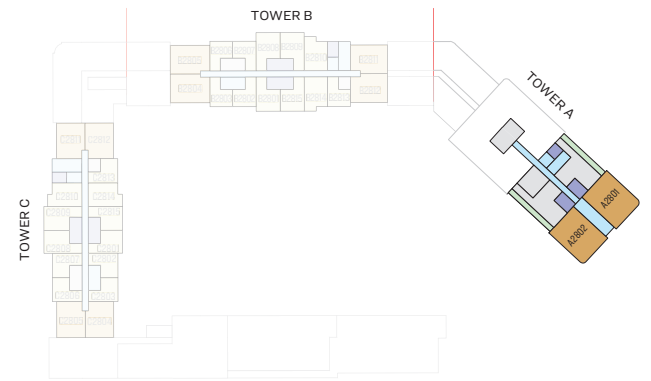

LEVEL 28

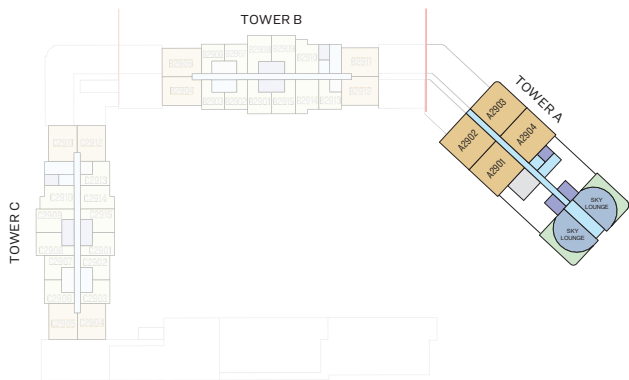

LEVEL 29

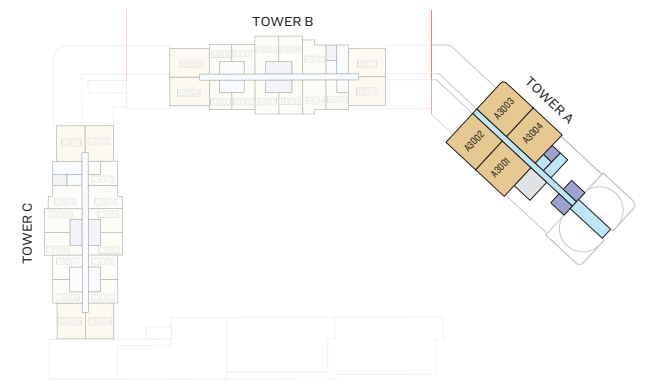

LEVEL 30

- | | |
|---|---|
|  1 BED UNIT |  SERVICES |
|  2 BED UNIT |  LIFT |
|  3 BED UNIT |  AMENITIES |
|  LOBBIES, CORRIDORS & STAIRS |  LANDSCAPE |

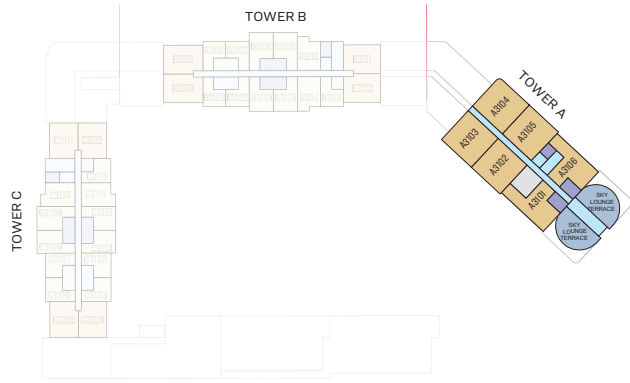
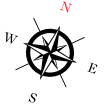

LEVEL 31

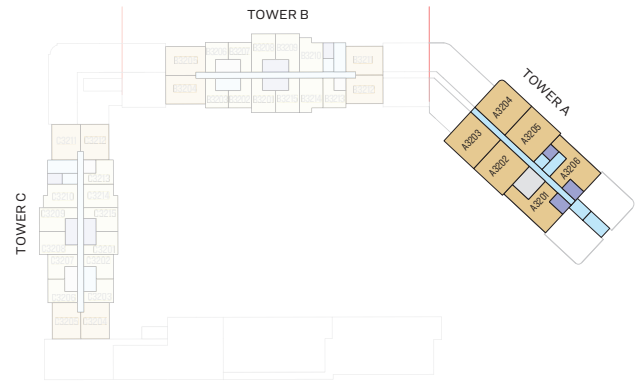

LEVEL 32

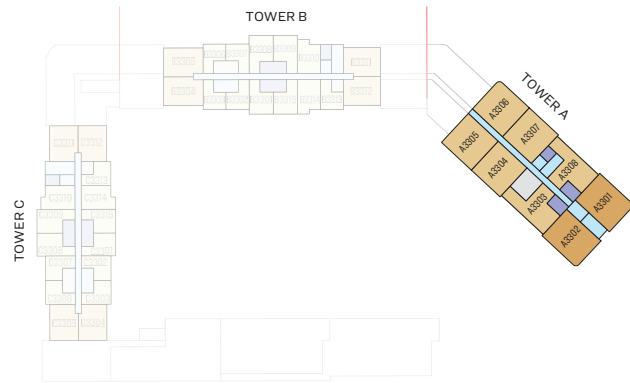

LEVEL 33

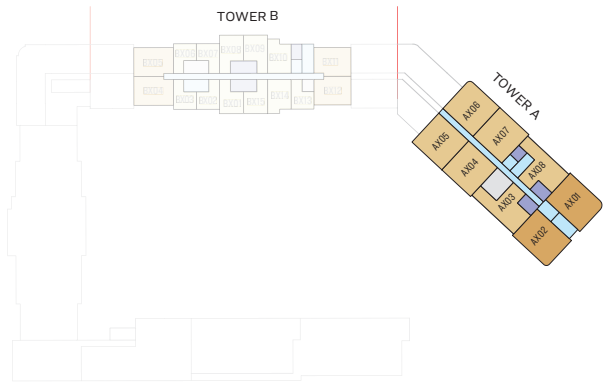

RESIDENTIAL UNITS

1 BEDROOM APARTMENT

TYPE A (with powder room + balcony)

TOTAL SALEABLE AREA

SUITE = 528.83 SQ.FT.
BALCONY = 44.24 SQ.FT.
TOTAL = 573.07 SQ.FT.

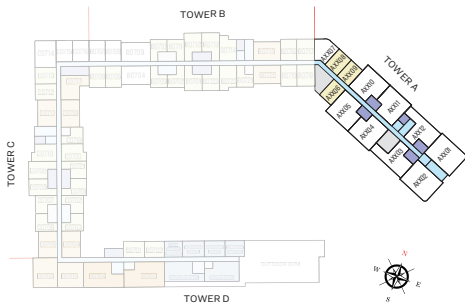

LEVEL 07-16 & 17-24

UNIT

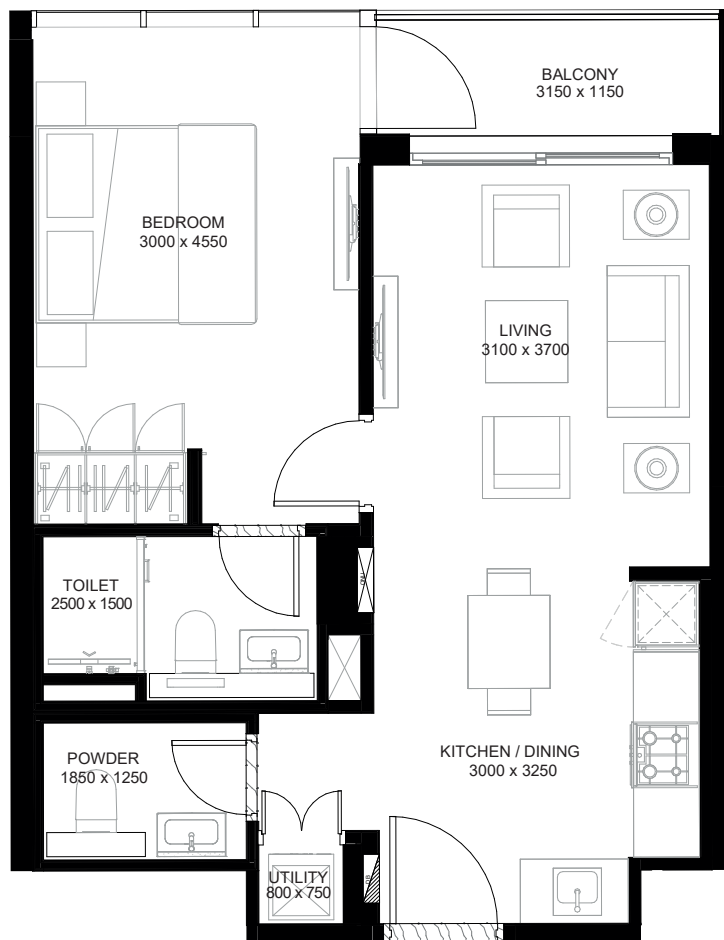

List of unit numbers with this unit plan:

VIEWS

Amenities

A0706, A0806, A0906, A1006, A1106

Amenities, Waterfront

A1206, A1306, A1406, A1506, A1606, A1706, A1806, A1906, A2006, A2106, A2206, A2306, A2406

Downtown, Sports Court, Ras Al Khor

A0708*, A0709*, A0808*, A0809*, A0908*, A0909*, A1008*, A1009*, A1108*, A1109*, A1208*, A1209*, A1308*, A1309*, A1408*, A1409*, A1508*, A1509*, A1608*, A1609*

* These apartments have mirrored units plans of the above

1 BEDROOM APARTMENT

TYPE A1 (with powder room + balcony)

TOTAL SALEABLE AREA

SUITE = 568.73 SQ.FT.

BALCONY = 122.22 SQ.FT.

TOTAL = 690.96 SQ.FT.

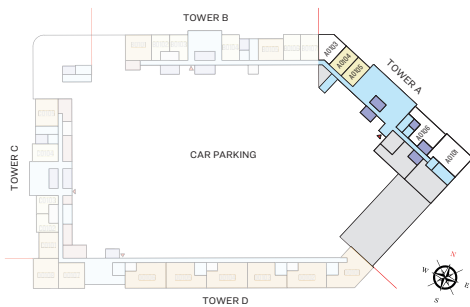

LEVEL 01(PODIUM 01)

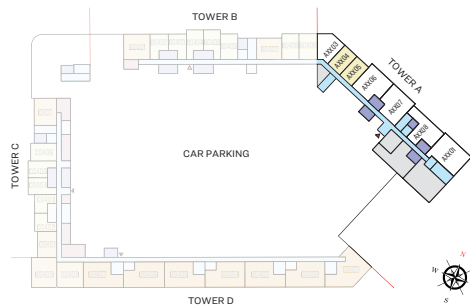

LEVEL 02-04

UNIT

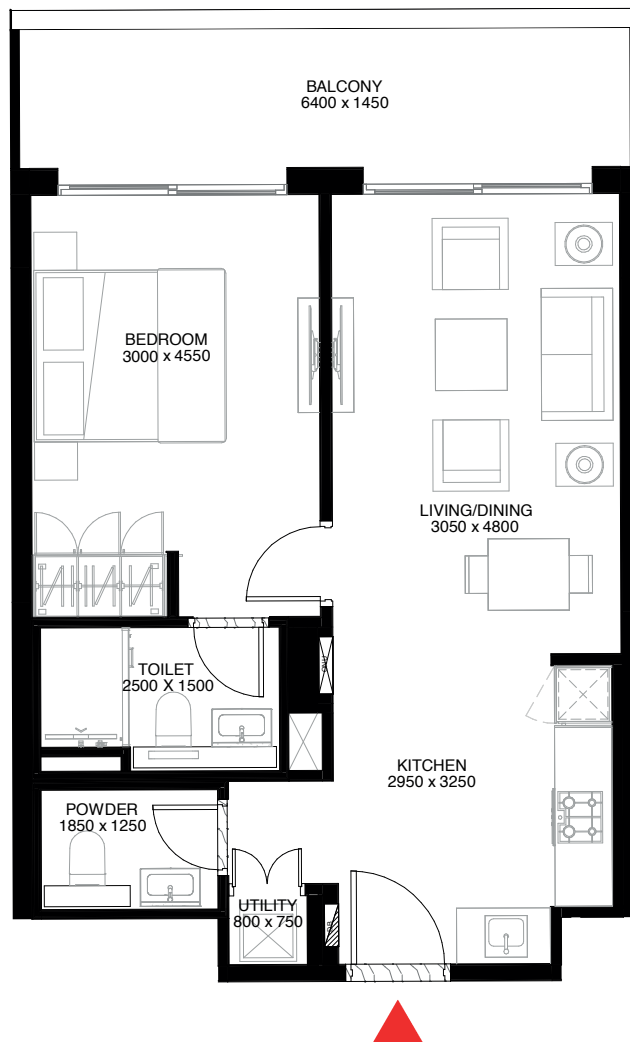

List of unit numbers with this unit plan:

VIEWS

Sports Court
A0104, A0105

Downtown, Sports Court
A0204, A0205, A0304, A0305, A0404, A0405

* These apartments have mirrored units plans of the above

1 BEDROOM APARTMENT

TYPE C (with powder room + balcony)

TOTAL SALEABLE AREA

SUITE = 634.75 SQ.FT.

BALCONY = 48.76 SQ.FT.

TOTAL = 683.51 SQ.FT.

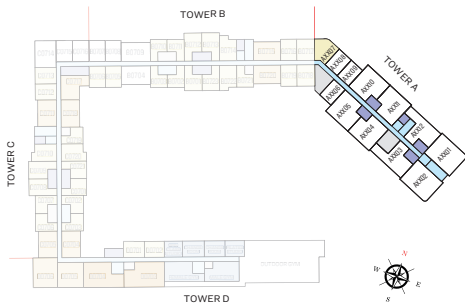

LEVEL 07-16

UNIT

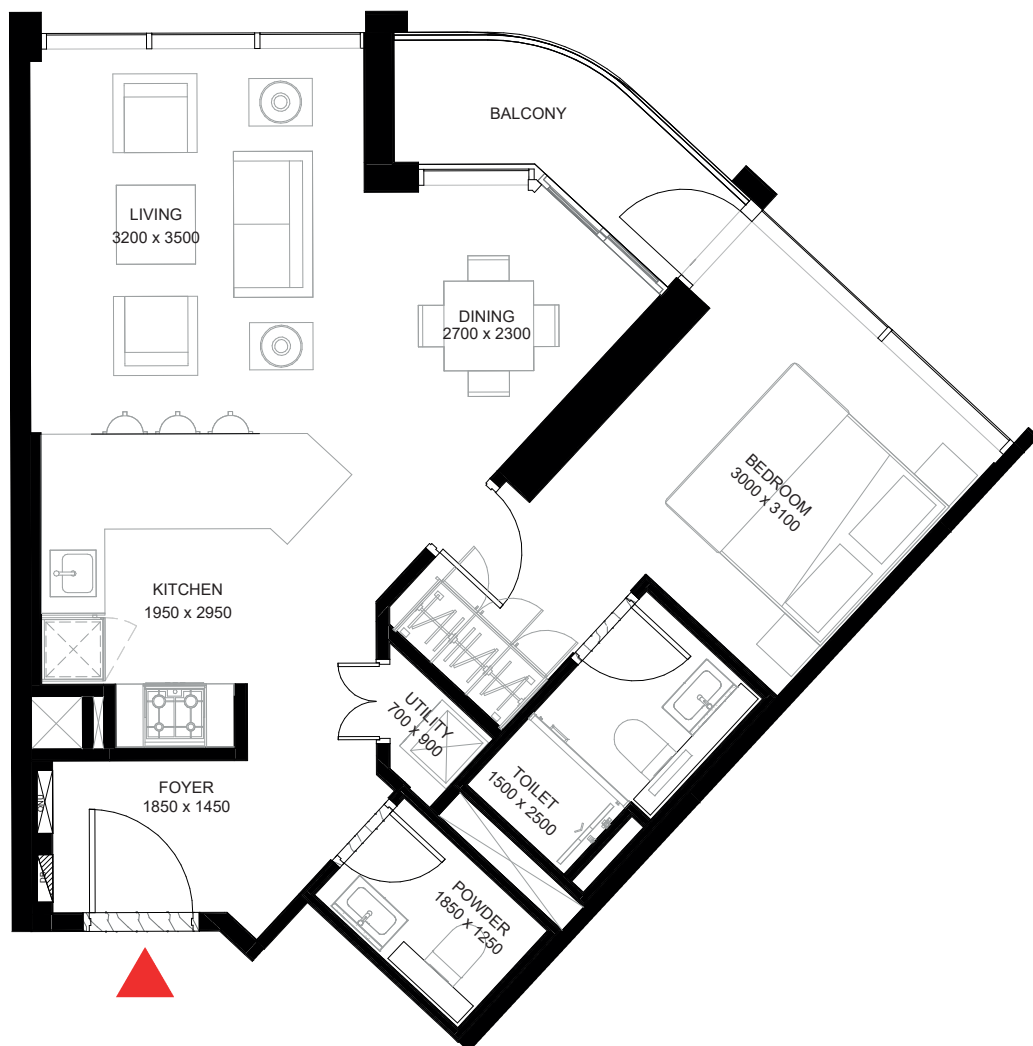

List of unit numbers with this unit plan:

VIEWS

Downtown, Sports Court, Ras Al Khor

A0707, A0807, A0907, A1007, A1107, A1207, A1307, A1407, A1507, A1607

* These apartments have mirrored units plans of the above

1 BEDROOM APARTMENT

TYPE C1 (with powder room + balcony)

TOTAL SALEABLE AREA

SUITE = 673.58 SQ.FT.
 BALCONY = 215.86 SQ.FT.
 TOTAL = 889.44 SQ.FT.

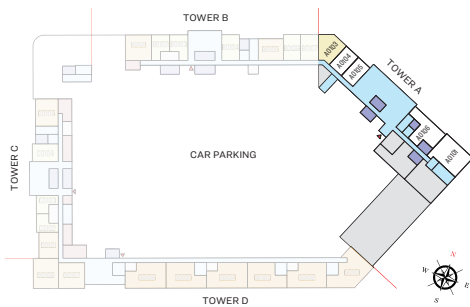

LEVEL 01

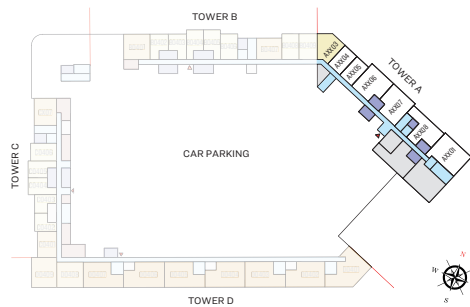

LEVEL 02-04

UNIT

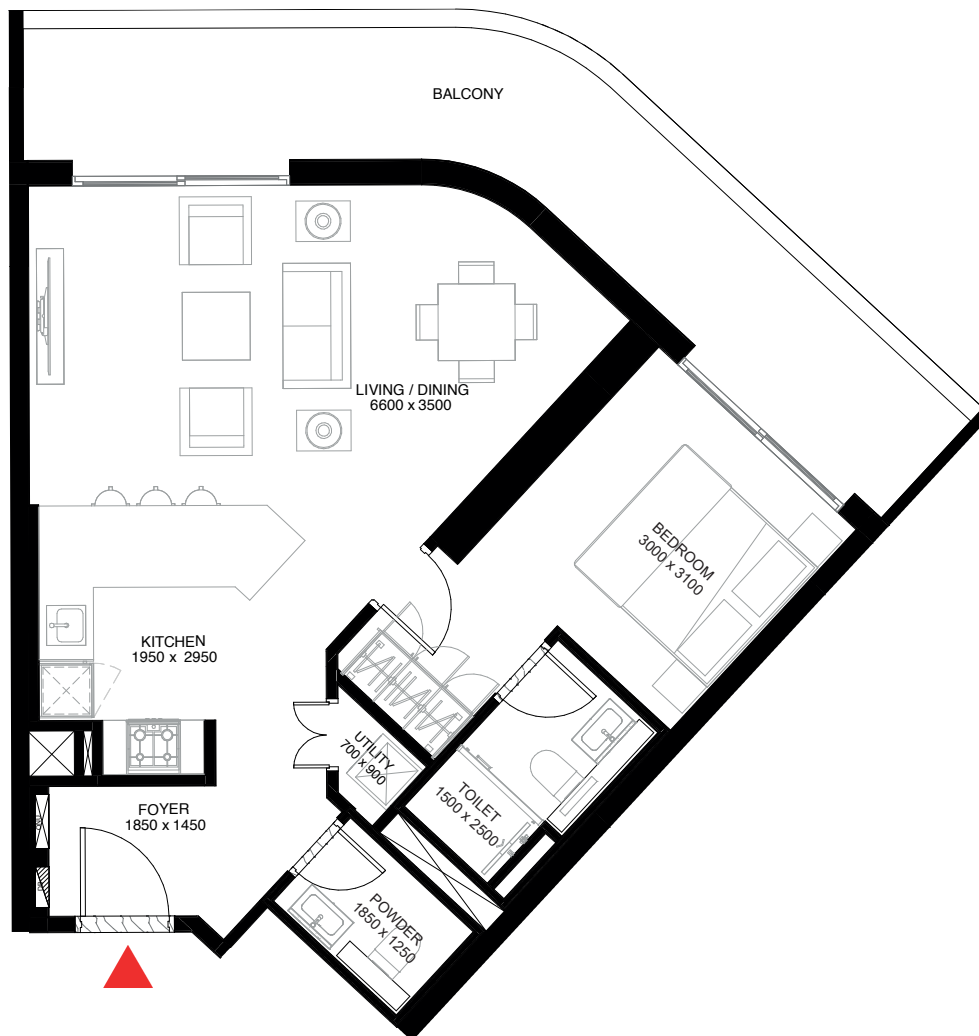

List of unit numbers with this unit plan:

VIEWS

Sports Court
 A0103

Downtown, Sports Court
 A0203, A0303, A0403

* These apartments have mirrored units plans of the above

2 BEDROOM APARTMENT TYPE C (with maid room + balcony)

TOTAL SALEABLE AREA

SUITE = 1209.86 SQ.FT.

BALCONY = 60.82 SQ.FT.

TOTAL = 1270.68 SQ.FT.

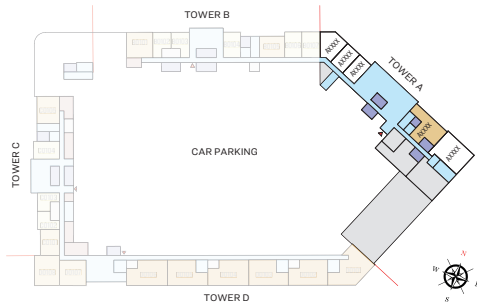

LEVEL 01-05

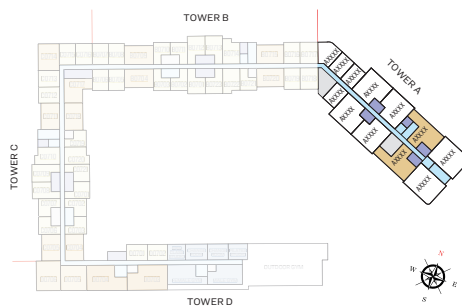

LEVEL 07-32

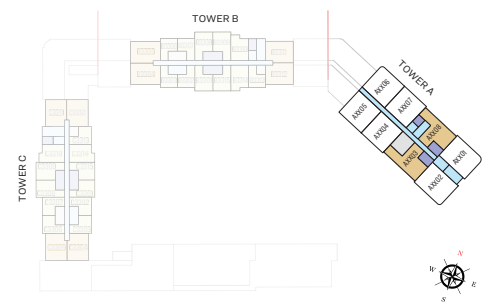

LEVEL 33-46

UNIT



List of unit numbers with this unit plan:

VIEWS

Sports Court
A0106*

Downtown, Sports Court
A0208*, A0308*, A0408*, A0505*

Downtown, Sports Court, Ras Al Khor
A0712*, A0812*, A0912*, A1012*, A1112*, A1212*, A1312*, A1412*, A1512*, A1612*, A1709*, A1809*, A1909*, A2009*, A2109*, A2209, A2309*, A2409*, A2508*, A2604*, A2704*, A3106*, A3206*, A3308*, A3408*, A3508*, A3608*, A3708*, A3808*, A3908*, A4008*, A4108*, A4208*, A4308*, A4408*, A4508*, A4608*

Amenities, Waterfront

A0703, A0803, A0903, A1003, A1103, A1203, A1303, A1403, A1503, A1603, A1703, A1803, A1903, A2003, A2103, A2203, A2303, A2403, A2503, A2603, A2703, A3101, A3201, A3303, A3403, A3503, A3603, A3703, A3803, A3903, A4003, A4103

Amenities, Waterfront, Downtown

A4203, A4303, A4403, A4503, A4603

* These apartments have mirrored units plans of the above

2 BEDROOM APARTMENT

TYPE D (with maid room + balcony)

TOTAL SALEABLE AREA

SUITE = 1157.34 SQ.FT.

BALCONY = 114.85 SQ.FT.

TOTAL = 1272.19 SQ.FT.

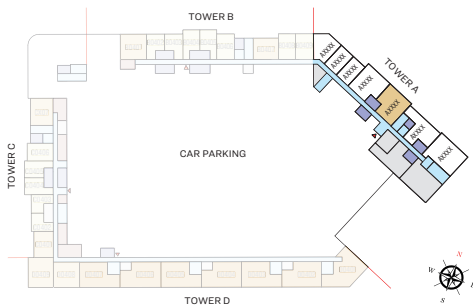

LEVEL 02-05

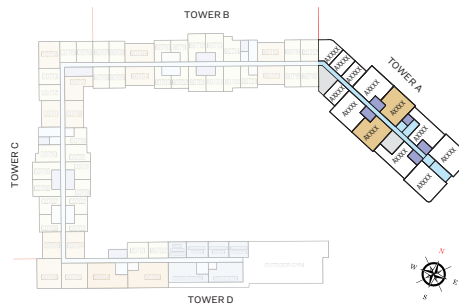

LEVEL 07-25

UNIT



List of unit numbers with this unit plan:

VIEWS

Amentites

A0704, A0804, A0904

Amenities, Waterfront

A1004, A1104, A1204, A1304, A1404, A1504, A1604, A1704, A1804, A1904, A2004, A2104, A2204, A2304, A2404, A2504

Downtown, Sports Court

A0207*, A0307*, A0407*, A0504*

Downtown, BK, Sports Court, Ras Al Khor

A0711*, A0811*, A0911*, A1011*, A1111*, A1211*, A1311*, A1411*, A1511*, A1611*, A1708*, A1808*, A1908*, A2008*, A2108*, A2208*, A2308*, A2408*, A2507*

* These apartments have mirrored units plans of the above

2 BEDROOM APARTMENT

TYPE E (with maid room + balcony)

TOTAL SALEABLE AREA

SUITE = 1170.36 SQ.FT.

BALCONY = 118.30 SQ.FT.

TOTAL = 1288.66 SQ.FT.

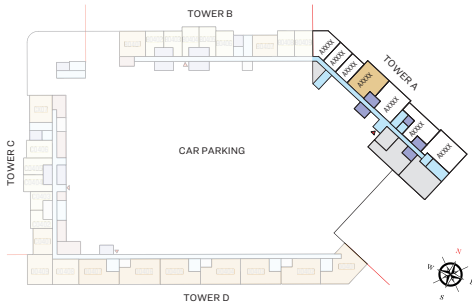

LEVEL 02-05

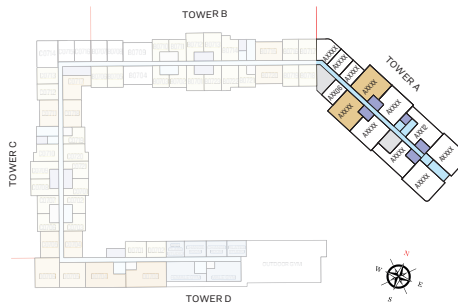

LEVEL 07-25

UNIT

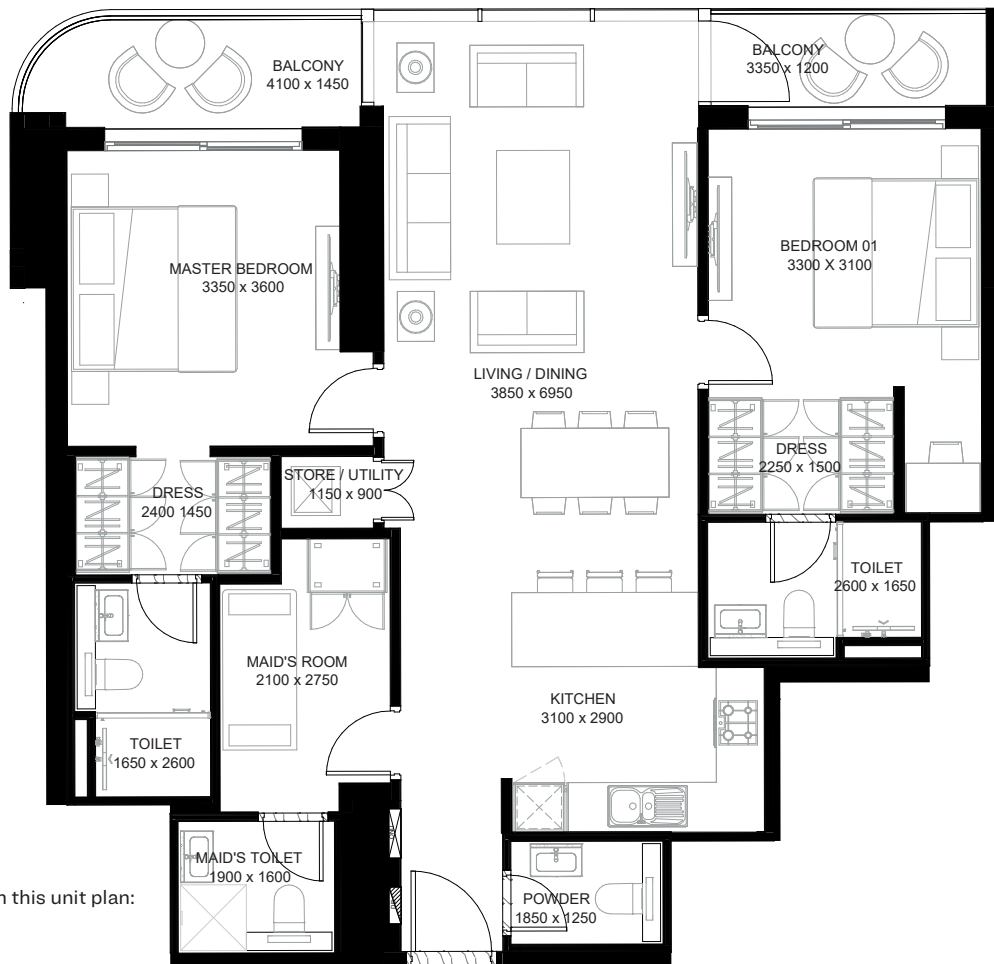

List of unit numbers with this unit plan:

VIEWS

Amenities

A0705, A0805, A0905

Amenities, Waterfront

A1005, A1105, A1205, A1305, A1405, A1505, A1605, A1705, A1805, A1905, A2005, A2105, A2205, A2305, A2405, A2505

Downtown, Sports Court

A0206*, A0306*, A0406*, A0503*

Downtown, Sports Court, Ras Al Khor

A0710*, A0810*, A0910*, A1010*, A1110*, A1210*, A1310*, A1410*, A1510*, A1610*, A1707*, A1807*, A1907*, A2007*, A2107*, A2207*, A2307*, A2407*, A2506*

* These apartments have mirrored units plans of the above

2 BEDROOM APARTMENT

TYPE F (with maid room + balcony)

TOTAL SALEABLE AREA

SUITE = 1279.51 SQ.FT.

BALCONY = 114.74 SQ.FT.

TOTAL = 1394.25 SQ.FT.

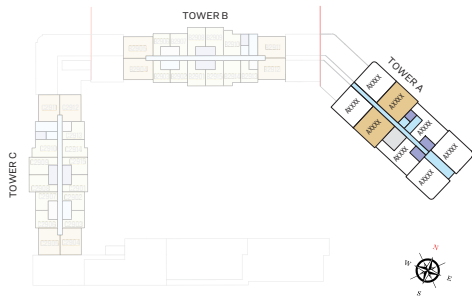

LEVEL 29-46

UNIT



List of unit numbers with this unit plan:

VIEWS

Amenities, Waterfront

A2901, A3001, A3102, A3202, A3304, A3404, A3504, A3604, A3704, A3804, A3904, A4004, A4104

Amenities, Waterfront, Downtown

A4204, A4304, A4404, A4504, A4604

Downtown, Sports Court, Ras Al Khor

A2904*, A3004*, A3105*, A3205*, A3307*, A3407*, A3507*, A3607*, A3707*, A3807*, A3907*, A4007*, A4107*, A4207*, A4307*, A4407*, A4507*, A4607*

* These apartments have mirrored units plans of the above

2 BEDROOM APARTMENT

TYPE G (with maid room + balcony)

TOTAL SALEABLE AREA

SUITE = 1270.25 SQ.FT.

BALCONY = 116.57 SQ.FT.

TOTAL = 1386.82 SQ.FT.

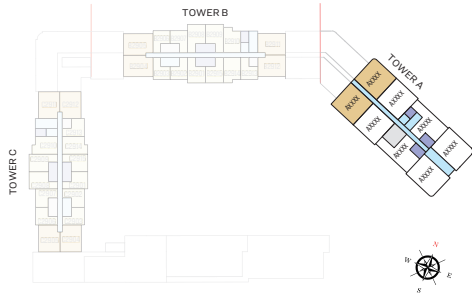

LEVEL 29-46

UNIT



List of unit numbers with this unit plan:

VIEWS

Downtown, Sports Court, Ras Al Khor

A2903*, A3003*, A3104*, A3204*, A3306*, A3406*, A3506*, A3606*, A3706*, A3806*, A3906*, A4006*, A4106*, A4206*, A4306*, A4406*, A4506*, A4606*

Amenities, Waterfront, Downtown

A2902, A3002, A3103, A3203, A3305, A3405, A3505, A3605, A3705, A3805, A3905, A4005, A4105, A4205, A4305, A4405, A4505, A4605

* These apartments have mirrored units plans of the above

3 BEDROOM APARTMENT

TYPE B (with maid room + balcony)

TOTAL SALEABLE AREA

SUITE = 1497.15 SQ.FT.

BALCONY = 68.24 SQ.FT.

TOTAL = 1565.40 SQ.FT.

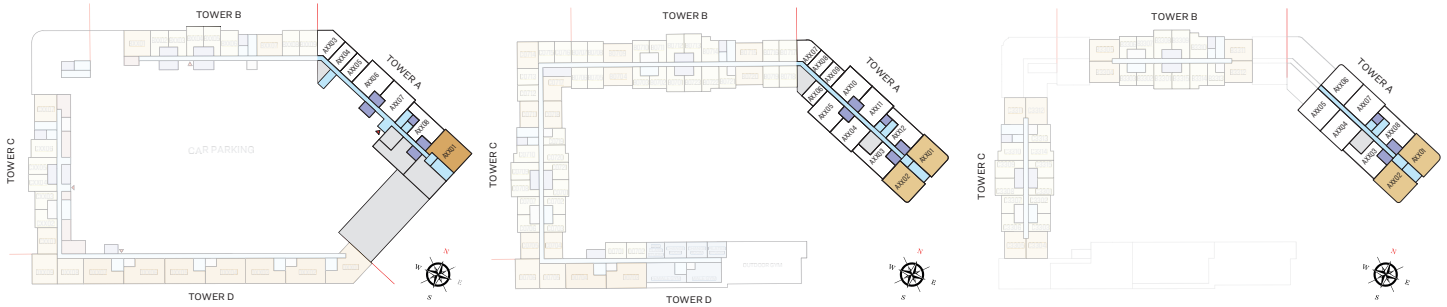

LEVEL 01-05

LEVEL 07-28

LEVEL 33-46

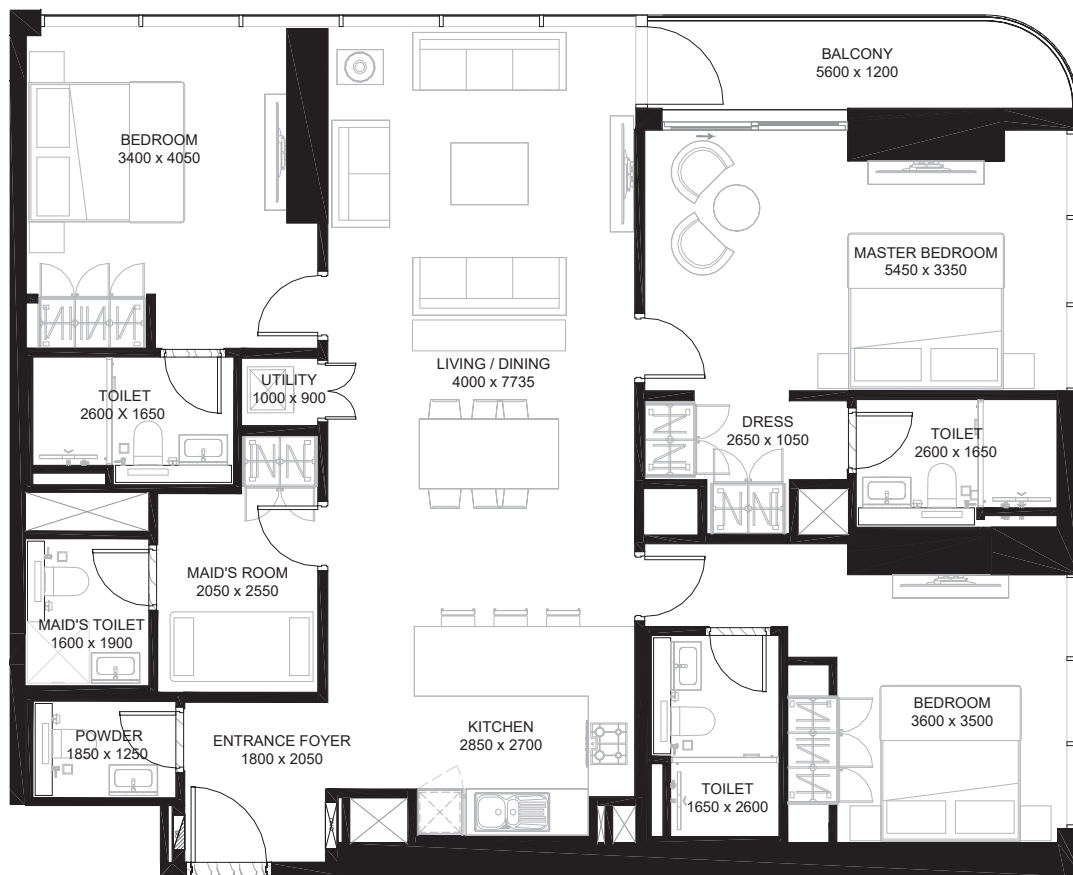

List of unit numbers with this unit plan:

VIEWS

Amenities, Waterfront

A0702*, A0802*, A0902*, A1002*, A1102*, A1202*, A1302*, A1402*, A1502*, A1602*, A1702*, A1802*, A1902*, A2002*, A2102*, A2202*, A2302*, A2402*, A2502*, A2602*, A2702*, A2802*, A3302*, A3402*, A3502*, A3602*, A3702*, A3802*, A3902*, A4002*, A4102*

Amenities, Waterfront, Downtown

A4202*, A4302*, A4402*, A4502*, A4602*

Sports Court

A0101

Downtown, Sports Court

A0201, A0301, A0401, A0501

Downtown, Sports Court, Ras Al Khor

A0701, A0801, A0901, A1001, A1101, A1201, A1301, A1401, A1501, A1601, A1701, A1801, A1901, A2001, A2101, A2201, A2301, A2401, A2501, A2601, A2701, A2801, A3301, A3401, A3501, A3601, A3701, A3801, A3901, A4001, A4101, A4201, A4301, A4401, A4501, A4601

* These apartments have mirrored units plans of the above



CONTACT US

Mobile: +971 52 554 9435

Email: info@propjunction.org

www.propjunction.ae/projects/the-crest

ADDRESS

B301, Metha plaza Building,
Oud Metha, Dubai