

# CREEK RISE

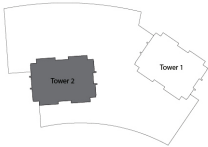

## 3 BEDROOM WITH BALCONY

TOWER 2  
UNIT 01 | LEVELS 12-27

Suite Area 1433.86 Sq.ft. / 133.21 Sq.m.  
Balcony Area 208.82 Sq.ft. / 19.40 Sq.m.  
Total Area 1642.68 Sq.ft. / 152.61 Sq.m.

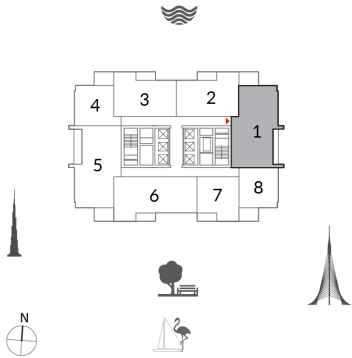

### FLOOR PLAN



1. All dimensions are in Imperial and metric, and measured from finish to finish excluding construction tolerances. 2. All materials, dimensions, and drawings are approximate only. 3. Information is subject to change without notice, at developer's absolute discretion. 4. Actual area may vary from the stated area. 5. Drawings not to scale. 6. All images used are for illustrative purposes only and do not represent the actual size, features, specifications, fittings, and furnishings. 7. The developer reserves the right to make revisions / alterations, at its absolute discretion, without any liability whatsoever.

# CREEK RISE

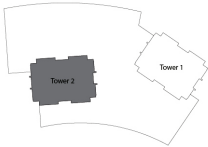

## 3 BEDROOM WITH BALCONY

TOWER 2  
UNIT 01 | LEVELS 12-27

Suite Area 1433.86 Sq.ft. / 133.21 Sq.m.  
Balcony Area 208.82 Sq.ft. / 19.40 Sq.m.  
Total Area 1642.68 Sq.ft. / 152.61 Sq.m.

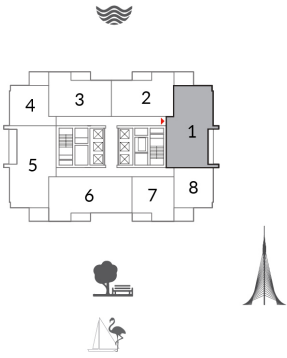

**FLOOR PLAN**



1. All dimensions are in Imperial and metric, and measured from finish to finish excluding construction tolerances. 2. All materials, dimensions, and drawings are approximate only. 3. Information is subject to change without notice, at developer's absolute discretion. 4. Actual area may vary from the stated area. 5. Drawings not to scale. 6. All images used are for illustrative purposes only and do not represent the actual size, features, specifications, fittings, and furnishings. 7. The developer reserves the right to make revisions / alterations, at its absolute discretion, without any liability whatsoever.

# CREEK RISE

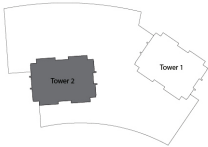

## 3 BEDROOM WITH BALCONY

TOWER 2  
UNIT 01 | LEVELS 12-27

Suite Area 1433.86 Sq.ft. / 133.21 Sq.m.  
Balcony Area 208.82 Sq.ft. / 19.40 Sq.m.  
Total Area 1642.68 Sq.ft. / 152.61 Sq.m.

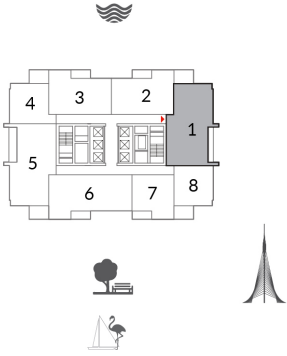

**FLOOR PLAN**



1. All dimensions are in Imperial and metric, and measured from finish to finish excluding construction tolerances. 2. All materials, dimensions, and drawings are approximate only. 3. Information is subject to change without notice, at developer's absolute discretion. 4. Actual area may vary from the stated area. 5. Drawings not to scale. 6. All images used are for illustrative purposes only and do not represent the actual size, features, specifications, fittings, and furnishings. 7. The developer reserves the right to make revisions / alterations, at its absolute discretion, without any liability whatsoever.

# CREEK RISE

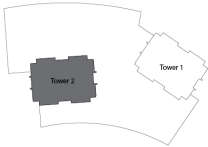

## 3 BEDROOM WITH BALCONY

TOWER 2  
UNIT 01 | LEVELS 12-27

Suite Area 1433.86 Sq.ft. / 133.21 Sq.m.  
Balcony Area 208.82 Sq.ft. / 19.40 Sq.m.  
Total Area 1642.68 Sq.ft. / 152.61 Sq.m.

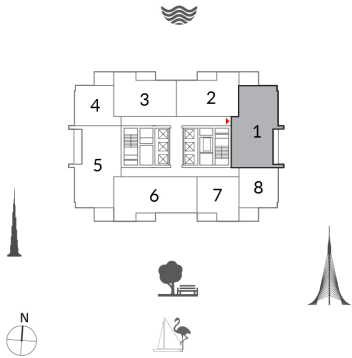

**FLOOR PLAN**



1. All dimensions are in Imperial and metric, and measured from finish to finish excluding construction tolerances. 2. All materials, dimensions, and drawings are approximate only. 3. Information is subject to change without notice, at developer's absolute discretion. 4. Actual area may vary from the stated area. 5. Drawings not to scale. 6. All images used are for illustrative purposes only and do not represent the actual size, features, specifications, fittings, and furnishings. 7. The developer reserves the right to make revisions / alterations, at its absolute discretion, without any liability whatsoever.



# CREEK RISE

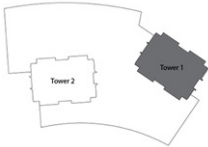

## 3 BEDROOM WITH BALCONY

TOWER 1  
UNIT 03 | LEVELS 18-36

Suite Area 1373.37 Sq.ft. / 127.59 Sq.m.

Balcony Area 68.03 Sq.ft. / 6.32 Sq.m.

Total Area 1441.40 Sq.ft. / 133.91 Sq.m.

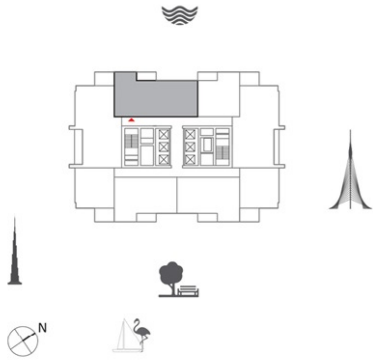

### FLOOR PLAN



1. All dimensions are in imperial and metric, and measured from finish to finish excluding construction tolerances. 2. All materials, dimensions, and drawings are approximate only. 3. Information is subject to change without notice, at developer's absolute discretion. 4. Actual area may vary from the stated area. 5. Drawings not to scale. 6. All images used are for illustrative purposes only and do not represent the actual size, features, specifications, fittings, and furnishings. 7. The developer reserves the right to make revisions / alterations, at it's absolute discretion, without any liability whatsoever.

# CREEK RISE

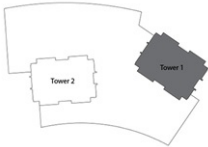

## 3 BEDROOM WITH BALCONY

TOWER 1  
UNIT 03 | LEVELS 18-36

Suite Area 1373.37 Sq.ft. / 127.59 Sq.m.

Balcony Area 68.03 Sq.ft. / 6.32 Sq.m.

Total Area 1441.40 Sq.ft. / 133.91 Sq.m.

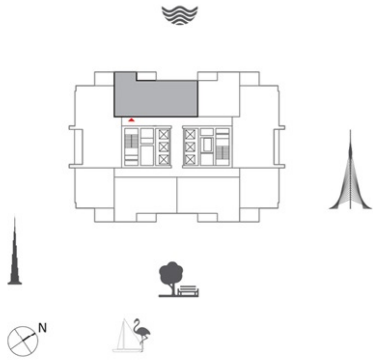

### FLOOR PLAN



1. All dimensions are in imperial and metric, and measured from finish to finish excluding construction tolerances. 2. All materials, dimensions, and drawings are approximate only. 3. Information is subject to change without notice, at developer's absolute discretion. 4. Actual area may vary from the stated area. 5. Drawings not to scale. 6. All images used are for illustrative purposes only and do not represent the actual size, features, specifications, fittings, and furnishings. 7. The developer reserves the right to make revisions / alterations, at it's absolute discretion, without any liability whatsoever.

# CREEK RISE

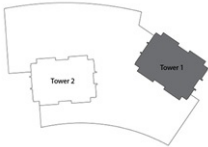

## 3 BEDROOM WITH BALCONY

TOWER 1  
UNIT 03 | LEVELS 18-36

Suite Area 1373.37 Sq.ft. / 127.59 Sq.m.

Balcony Area 68.03 Sq.ft. / 6.32 Sq.m.

Total Area 1441.40 Sq.ft. / 133.91 Sq.m.

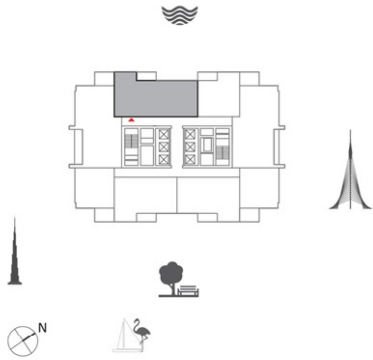

### FLOOR PLAN



1. All dimensions are in imperial and metric, and measured from finish to finish excluding construction tolerances. 2. All materials, dimensions, and drawings are approximate only. 3. Information is subject to change without notice, at developer's absolute discretion. 4. Actual area may vary from the stated area. 5. Drawings not to scale. 6. All images used are for illustrative purposes only and do not represent the actual size, features, specifications, fittings, and furnishings. 7. The developer reserves the right to make revisions / alterations, at it's absolute discretion, without any liability whatsoever.

# CREEK RISE

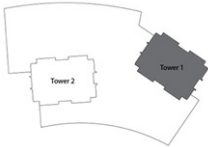

## 3 BEDROOM WITH BALCONY

TOWER 1  
UNIT 03 | LEVELS 18-36

Suite Area 1373.37 Sq.ft. / 127.59 Sq.m.

Balcony Area 68.03 Sq.ft. / 6.32 Sq.m.

Total Area 1441.40 Sq.ft. / 133.91 Sq.m.

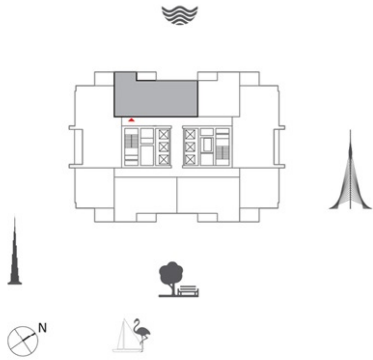

### FLOOR PLAN



1. All dimensions are in imperial and metric, and measured from finish to finish excluding construction tolerances. 2. All materials, dimensions, and drawings are approximate only. 3. Information is subject to change without notice, at developer's absolute discretion. 4. Actual area may vary from the stated area. 5. Drawings not to scale. 6. All images used are for illustrative purposes only and do not represent the actual size, features, specifications, fittings, and furnishings. 7. The developer reserves the right to make revisions / alterations, at it's absolute discretion, without any liability whatsoever.

# CREEK RISE

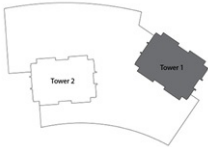

## 3 BEDROOM WITH BALCONY

TOWER 1  
UNIT 03 | LEVELS 18-36

Suite Area 1373.37 Sq.ft. / 127.59 Sq.m.

Balcony Area 68.03 Sq.ft. / 6.32 Sq.m.

Total Area 1441.40 Sq.ft. / 133.91 Sq.m.

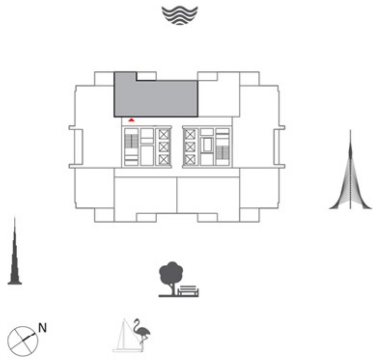

**FLOOR PLAN**



1. All dimensions are in imperial and metric, and measured from finish to finish excluding construction tolerances. 2. All materials, dimensions, and drawings are approximate only. 3. Information is subject to change without notice, at developer's absolute discretion. 4. Actual area may vary from the stated area. 5. Drawings not to scale. 6. All images used are for illustrative purposes only and do not represent the actual size, features, specifications, fittings, and furnishings. 7. The developer reserves the right to make revisions / alterations, at it's absolute discretion, without any liability whatsoever.

# CREEK RISE

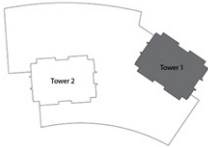

## 3 BEDROOM WITH BALCONY

TOWER 1  
UNIT 03 | LEVELS 18-36

Suite Area 1373.37 Sq.ft. / 127.59 Sq.m.

Balcony Area 68.03 Sq.ft. / 6.32 Sq.m.

Total Area 1441.40 Sq.ft. / 133.91 Sq.m.

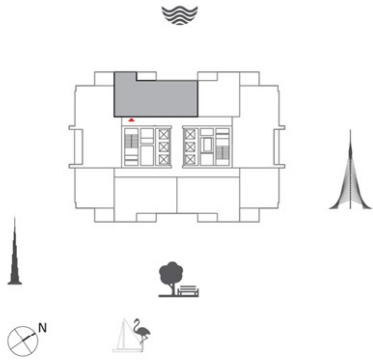

### FLOOR PLAN



1. All dimensions are in imperial and metric, and measured from finish to finish excluding construction tolerances. 2. All materials, dimensions, and drawings are approximate only. 3. Information is subject to change without notice, at developer's absolute discretion. 4. Actual area may vary from the stated area. 5. Drawings not to scale. 6. All images used are for illustrative purposes only and do not represent the actual size, features, specifications, fittings, and furnishings. 7. The developer reserves the right to make revisions / alterations, at it's absolute discretion, without any liability whatsoever.

# CREEK RISE

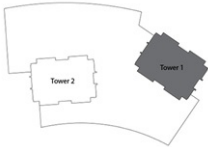

## 3 BEDROOM WITH BALCONY

TOWER 1  
UNIT 03 | LEVELS 18-36

Suite Area 1373.37 Sq.ft. / 127.59 Sq.m.

Balcony Area 68.03 Sq.ft. / 6.32 Sq.m.

Total Area 1441.40 Sq.ft. / 133.91 Sq.m.

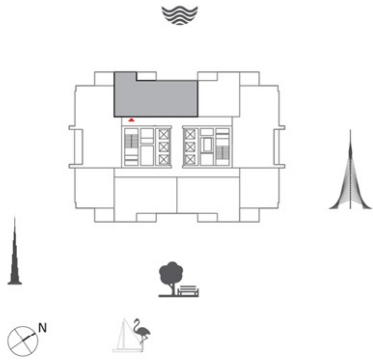

**FLOOR PLAN**



1. All dimensions are in imperial and metric, and measured from finish to finish excluding construction tolerances. 2. All materials, dimensions, and drawings are approximate only. 3. Information is subject to change without notice, at developer's absolute discretion. 4. Actual area may vary from the stated area. 5. Drawings not to scale. 6. All images used are for illustrative purposes only and do not represent the actual size, features, specifications, fittings, and furnishings. 7. The developer reserves the right to make revisions / alterations, at its absolute discretion, without any liability whatsoever.



# CREEK RISE

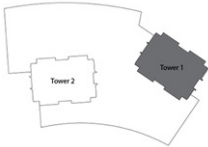

## 3 BEDROOM WITH BALCONY

TOWER 1  
UNIT 03 | LEVELS 18-36

Suite Area 1373.37 Sq.ft. / 127.59 Sq.m.

Balcony Area 68.03 Sq.ft. / 6.32 Sq.m.

Total Area 1441.40 Sq.ft. / 133.91 Sq.m.

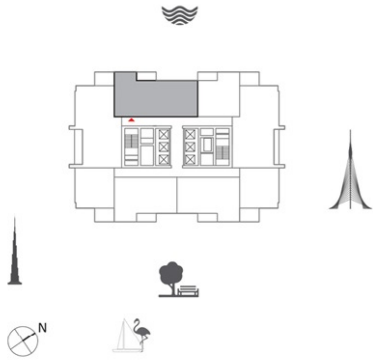

### FLOOR PLAN



1. All dimensions are in imperial and metric, and measured from finish to finish excluding construction tolerances. 2. All materials, dimensions, and drawings are approximate only. 3. Information is subject to change without notice, at developer's absolute discretion. 4. Actual area may vary from the stated area. 5. Drawings not to scale. 6. All images used are for illustrative purposes only and do not represent the actual size, features, specifications, fittings, and furnishings. 7. The developer reserves the right to make revisions / alterations, at it's absolute discretion, without any liability whatsoever.

# DUBAI CREEK HARBOUR

## CREEK RISE

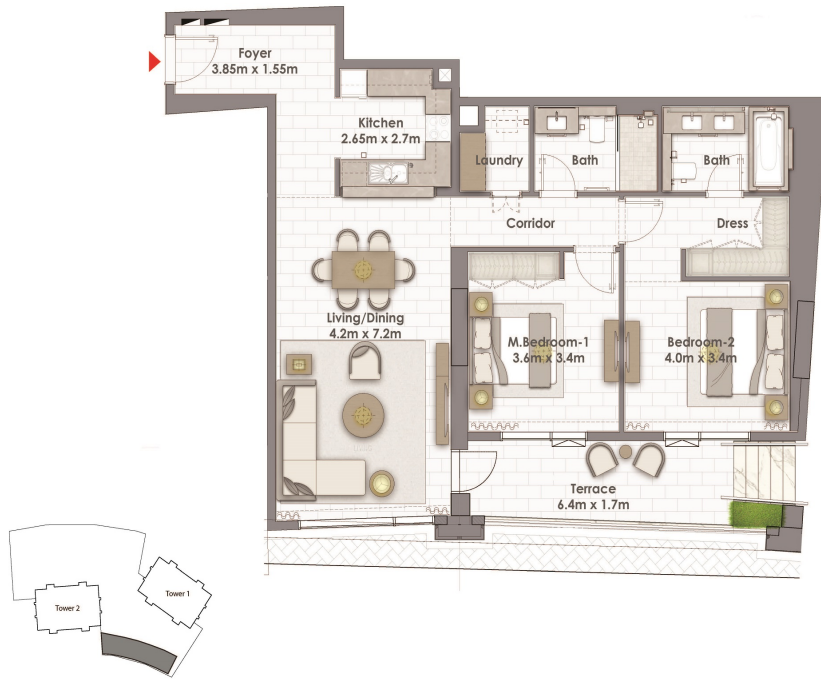

## 2 BEDROOM WITH TERRACE

PARK SIDE  
UNIT 07 | GROUND LEVEL

Suite Area 1255.29 Sq.ft. / 116.62 Sq.m.  
Balcony Area 283.52 Sq.ft. / 26.34 Sq.m.  
Total Area 1538.81 Sq.ft. / 142.96 Sq.m.

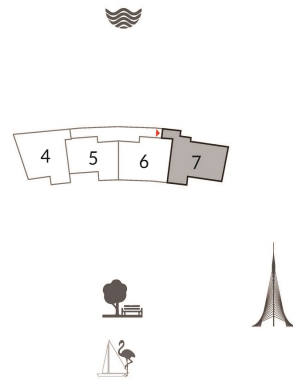

1. All dimensions are in imperial and metric, and measured from finish to finish excluding construction tolerances. 2. All materials, dimensions, and drawings are approximate only. 3. Information is subject to change without notice, at developer's absolute discretion. 4. Actual area may vary from the stated area. 5. Drawings not to scale. 6. All images used are for illustrative purposes only and do not represent the actual size, features, specifications, fittings, and furnishings. 7. The developer reserves the right to make revisions/ alterations, at its absolute discretion, without any liability whatsoever.

# DUBAI CREEK

## HARBOUR

### CREEK RISE

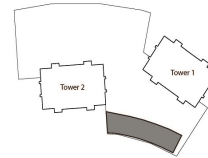

## 2 BEDROOM WITH TERRACE

PARK SIDE  
UNIT 04 | GROUND LEVEL

Suite Area 1250.77 Sq.ft. / 116.20 Sq.m.

Balcony Area 102.26 Sq.ft. / 9.50 Sq.m.

Total Area 1353.03 Sq.ft. / 125.70 Sq.m.

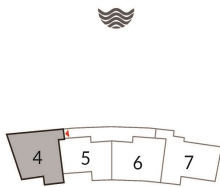

1. All dimensions are in imperial and metric, and measured from finish to finish excluding construction tolerances. 2. All materials, dimensions, and drawings are approximate only. 3. Information is subject to change without notice, at developer's absolute discretion. 4. Actual area may vary from the stated area. 5. Drawings not to scale. 6. All images used are for illustrative purposes only and do not represent the actual size, features, specifications, fittings, and furnishings. 7. The developer reserves the right to make revisions/ alterations, at its absolute discretion, without any liability whatsoever.

# DUBAI CREEK HARBOUR

## CREEK RISE

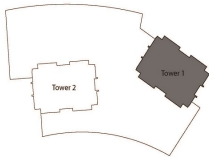

### 2 BEDROOM WITH BALCONY

TOWER 1  
UNIT 04 | PODIUM LEVEL

Suite Area 1077.36 Sq.ft. / 100.09 Sq.m.

Balcony Area 240.04 Sq.ft. / 22.30 Sq.m.

Total Area 1317.40 Sq.ft. / 122.39 Sq.m.

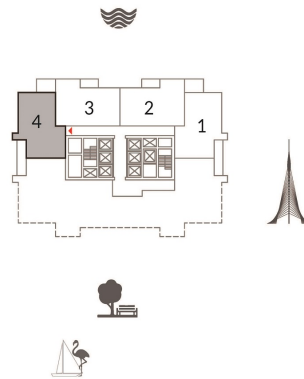

1. All dimensions are in imperial and metric, and measured from finish to finish excluding construction tolerances. 2. All materials, dimensions, and drawings are approximate only. 3. Information is subject to change without notice, at developer's absolute discretion. 4. Actual area may vary from the stated area. 5. Drawings not to scale. 6. All images used are for illustrative purposes only and do not represent the actual size, features, specifications, fittings, and furnishings. 7. The developer reserves the right to make revisions/ alterations, at its absolute discretion, without any liability whatsoever.

# DUBAI CREEK HARBOUR

## CREEK RISE

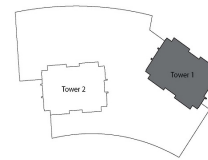

### 2 BEDROOM WITH BALCONY

TOWER 1  
UNIT 03 | FIRST FLOOR

Suite Area 1038.72 Sq.ft. / 96.50 Sq.m.

Balcony Area 63.29 Sq.ft. / 5.88 Sq.m.

Total Area 1102.01 Sq.ft. / 102.38 Sq.m.

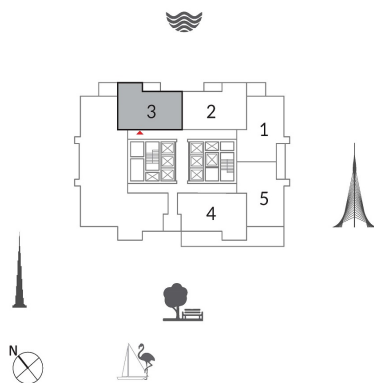

1. All dimensions are in imperial and metric, and measured from finish to finish excluding construction tolerances. 2. All materials, dimensions, and drawings are approximate only. 3. Information is subject to change without notice, at developer's absolute discretion. 4. Actual area may vary from the stated area. 5. Drawings not to scale. 6. All images used are for illustrative purposes only and do not represent the actual size, features, specifications, fittings, and furnishings. 7. The developer reserves the right to make revisions/ alterations, at its absolute discretion, without any liability whatsoever.

# DUBAI CREEK HARBOUR

## CREEK RISE

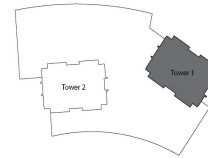
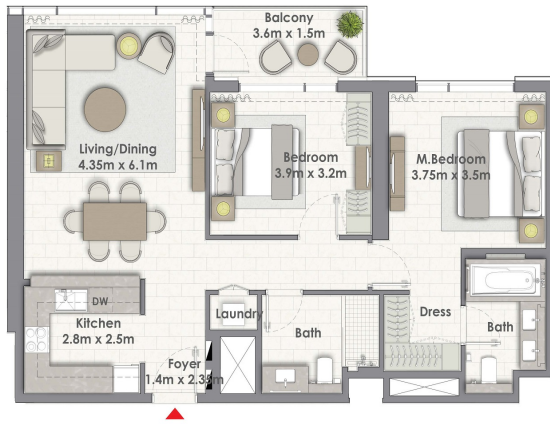

### 2 BEDROOM WITH BALCONY

TOWER 1  
UNIT 03 | FIRST FLOOR

Suite Area 1038.72 Sq.ft. / 96.50 Sq.m.

Balcony Area 63.29 Sq.ft. / 5.88 Sq.m.

Total Area 1102.01 Sq.ft. / 102.38 Sq.m.

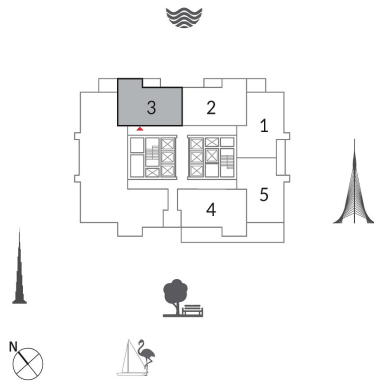

1. All dimensions are in imperial and metric, and measured from finish to finish excluding construction tolerances. 2. All materials, dimensions, and drawings are approximate only. 3. Information is subject to change without notice, at developer's absolute discretion. 4. Actual area may vary from the stated area. 5. Drawings not to scale. 6. All images used are for illustrative purposes only and do not represent the actual size, features, specifications, fittings, and furnishings. 7. The developer reserves the right to make revisions/ alterations, at its absolute discretion, without any liability whatsoever.

# DUBAI CREEK HARBOUR

## CREEK RISE

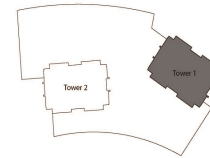

### 2 BEDROOM WITH BALCONY

TOWER 1  
UNIT 03 | PODIUM LEVEL

Suite Area 1033.23 Sq.ft. / 95.99 Sq.m.

Balcony Area 63.29 Sq.ft. / 5.88 Sq.m.

Total Area 1096.52 Sq.ft. / 101.87 Sq.m.

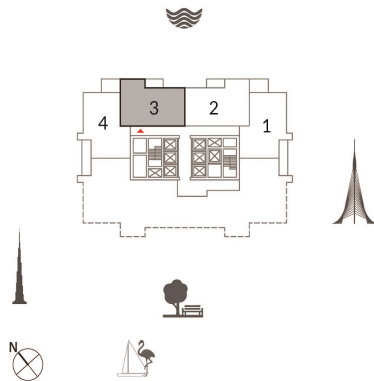

1. All dimensions are in imperial and metric, and measured from finish to finish excluding construction tolerances. 2. All materials, dimensions, and drawings are approximate only. 3. Information is subject to change without notice, at developer's absolute discretion. 4. Actual area may vary from the stated area. 5. Drawings not to scale. 6. All images used are for illustrative purposes only and do not represent the actual size, features, specifications, fittings, and furnishings. 7. The developer reserves the right to make revisions/ alterations, at its absolute discretion, without any liability whatsoever.



# DUBAI CREEK HARBOUR

## CREEK RISE

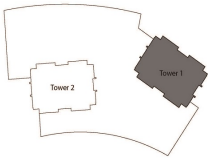

## 2 BEDROOM WITH BALCONY

TOWER 1  
UNIT 02 | PODIUM LEVEL

Suite Area 1033.23 Sq.ft. / 95.99 Sq.m.

Balcony Area 63.29 Sq.ft. / 5.88 Sq.m.

Total Area 1096.52 Sq.ft. / 101.87 Sq.m.

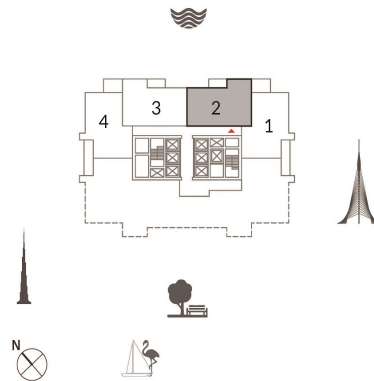

1. All dimensions are in imperial and metric, and measured from finish to finish excluding construction tolerances. 2. All materials, dimensions, and drawings are approximate only. 3. Information is subject to change without notice, at developer's absolute discretion. 4. Actual area may vary from the stated area. 5. Drawings not to scale. 6. All images used are for illustrative purposes only and do not represent the actual size, features, specifications, fittings, and furnishings. 7. The developer reserves the right to make revisions/ alterations, at its absolute discretion, without any liability whatsoever.

# DUBAI CREEK

## HARBOUR

### CREEK RISE



## 2 BEDROOM WITH TERRACE

TOWER 1  
UNIT 04 | FIRST FLOOR

Suite Area 1036.89 Sq.ft. / 96.33 Sq.m.  
Balcony Area 313.88 Sq.ft. / 29.16 Sq.m.  
Total Area 1350.77 Sq.ft. / 125.49 Sq.m.



1. All dimensions are in imperial and metric, and measured from finish to finish excluding construction tolerances. 2. All materials, dimensions, and drawings are approximate only. 3. Information is subject to change without notice, at developer's absolute discretion. 4. Actual area may vary from the stated area. 5. Drawings not to scale. 6. All images used are for illustrative purposes only and do not represent the actual size, features, specifications, fittings, and furnishings. 7. The developer reserves the right to make revisions/ alterations, at its absolute discretion, without any liability whatsoever.

# DUBAI CREEK HARBOUR

## CREEK RISE

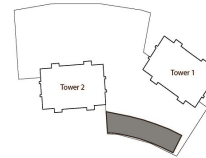

### 2 BEDROOM WITH TERRACE

PARKSIDE  
UNIT 06 | GROUND LEVEL

Suite Area 1025.59 Sq.ft. / 95.28 Sq.m.  
Balcony Area 142.84 Sq.ft. / 13.27 Sq.m.  
Total Area 1168.43 Sq.ft. / 108.55 Sq.m.

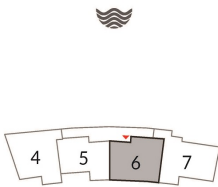

1. All dimensions are in imperial and metric, and measured from finish to finish excluding construction tolerances. 2. All materials, dimensions, and drawings are approximate only. 3. Information is subject to change without notice, at developer's absolute discretion. 4. Actual area may vary from the stated area. 5. Drawings not to scale. 6. All images used are for illustrative purposes only and do not represent the actual size, features, specifications, fittings, and furnishings. 7. The developer reserves the right to make revisions/ alterations, at its absolute discretion, without any liability whatsoever.